

Ordering Code: **ML-2A3-X-Y 02-Z**

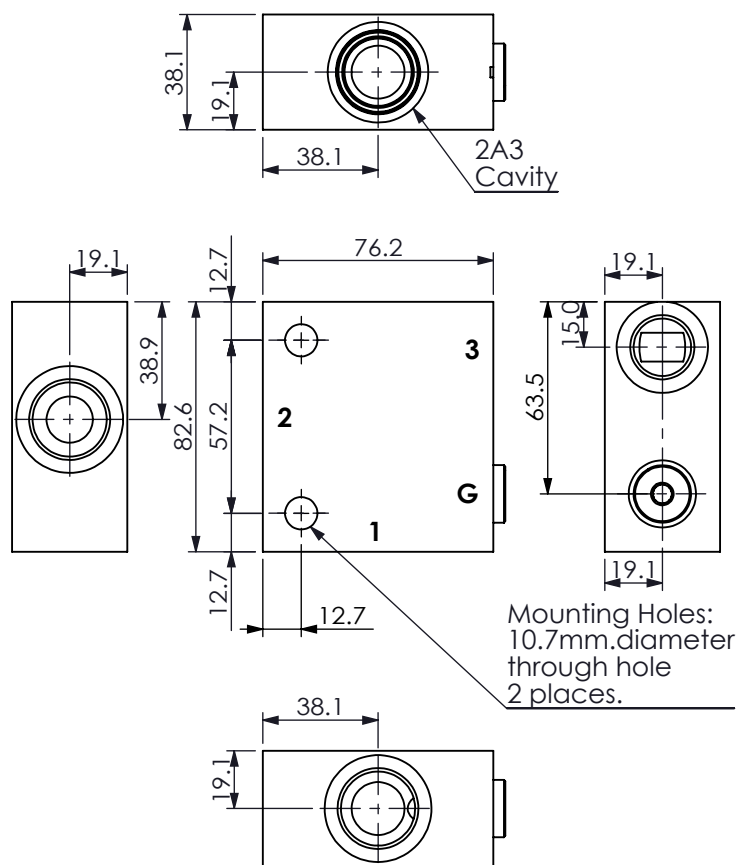

UNIT:mm

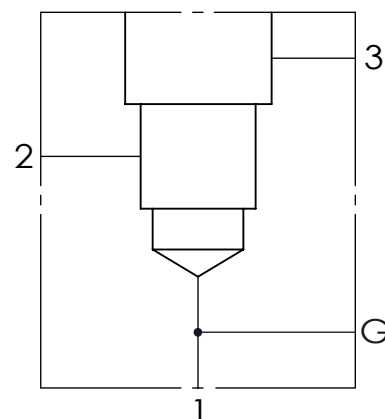

### TECHNICAL DATA

Aluminum Body Pressure Rating: 210 bar

Steel Body Pressure Rating: 350 bar

Cavity:

Refer to 2A3

\* Refer to Winner Cartridge Valves Catalog.

Aluminum	0.53 kg(WITHOUT VALVES)
Steel	1.4 kg(WITHOUT VALVES)

\* If you need the special specification.  
Please contact us.

### PORT SIZE

X	PORTS	PORT	PORT	
	1,2	3	G	
G06BG	G 3/4"	G 1/2"	G 1/4"	

### Y BODY MATERIAL

**A** HIGH-STRENGTH ALUMINUM

**T** STEEL (black oxide)

### Z CARTRIDGE VALVES SELECTION

WITHOUT VALVE

**PPOA** PP2A30AL (80LPM,7-210bar)

**PDOA** PD2A30AL (80LPM,50-210bar)

Please refer to the list price of cartridge program.