

Ordering Code: **ML-22M3-X-Y 01-Z**

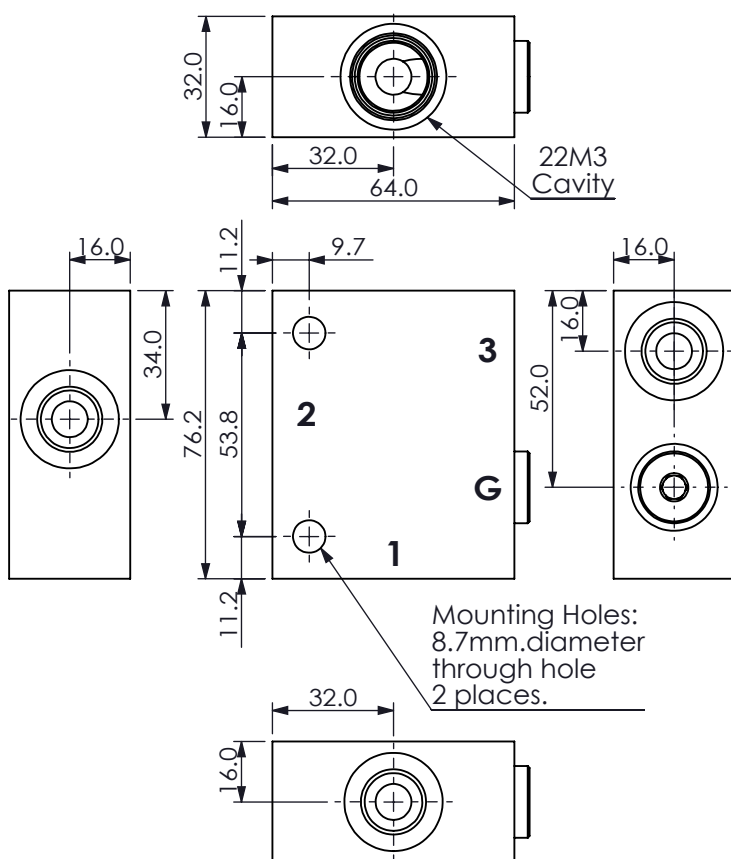

UNIT:mm

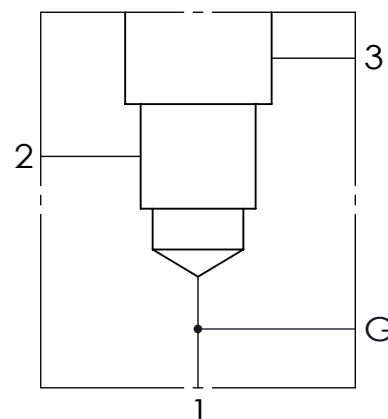

TECHNICAL DATA

Aluminum Body Pressure Rating: 210 bar

Steel Body Pressure Rating: 350 bar

Cavity:

Refer to 22M3

* Refer to Winner Cartridge Valves Catalog.

Aluminum	0.35 kg(WITHOUT VALVES)
Steel	0.98 kg(WITHOUT VALVES)

* If you need the special specification.
Please contact us.

PORT SIZE

X	PORTS	PORT	PORT	
	1,2	3	G	
G02G	G 1/4"	G 1/4"	G 1/4"	
G03G	G 3/8"	G 3/8"	G 1/4"	

Y BODY MATERIAL

A HIGH-STRENGTH ALUMINUM

T STEEL (black oxide)

Z CARTRIDGE VALVES SELECTION

WITHOUT VALVE

CO50 CO22M3C50N(30LPM,5.0bar)

Please refer to the list price of cartridge program.